

Smart Automated
Rotating Makeup Brush

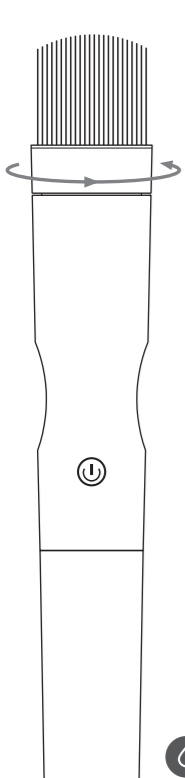

Product Introduction

This Smart Automated Rotating Makeup Brush rotates 360° to apply your makeup evenly for a flawless, natural looking finish. Whether you're a beginner or a professional, it delivers makeup artist results every single time.

With an ergonomic al-alloy device designed for comfort and easy control, its patent pending design delivers about 180-220 revolutions per minute for fast, even coverage.

This Smart Automated Rotating Makeup Brush Kit is not only easier to use with better results than a traditional makeup brush, but more economical, too. Better blending means less makeup.

Interchangeable brush heads are made of high quality, soft hair for guaranteed performance and longevity. The synthetic hair is washable and cruelty-free.

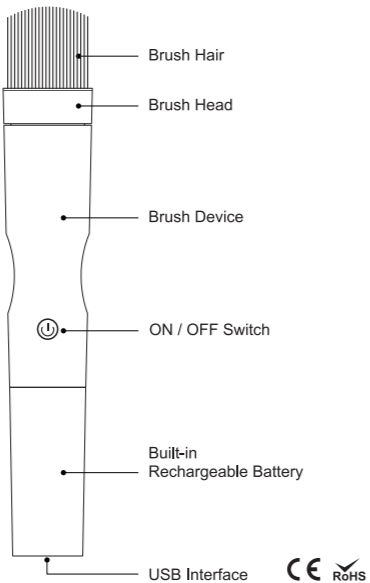

Precautions

- Remove the brush head from the device to clean the hair with water for the first using.
- Do not pull on the brush hair when removing from the device.
- Do not get device wet or immerse in water which can cause risk of electrical shock.
- Keep the brush in Mode 2 with sensitive areas like your eyes and mouth.
- Dry on its side and wait until fully dry before using.
- When power on, please tell the children not to play with the product.
- Do not use the brush in places with flammable gas or explosive dust, expose to high temperatures, or drop it into fire.
- Do not dismantle the product.
- Do not do any danger for this automated makeup brush, specification to use.
- Keep the rechargeable battery safe whenever use or not.

*Any loss resulted from violation of above rules will not be borne by our company.

Maintenance

- 1.Before /after use, please clean the brush hair, and put it into the brush guard after use.
- 2.To achieve the best makeup effect, it is recommended every three months to replace a brush head.

Prepare to Use

Attach Brush Head

Make sure the on/off switch is in the "off" position. Insert the brush head straight into the device until the brush head reaches the bottom.

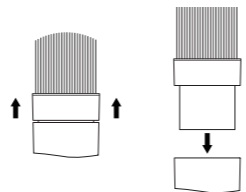

Replace Brush Head

Grasp the base of the brush head and pull it out from the device. Do not pull on the brush hair while removing.

Smart Makeup

Apply your makeup evenly and flawlessly

Slip Brush Guard

Slip the brush guard over the brush device until it extend beyond the brush hair. Don't slide back towards the brush device nor crush the brush hair. Or use other guard to protect the brush hair.

Charging Instructions

- Make sure the device is switched off when you start to charge it.
- Place the USB charging cable to the bottom of the device, and make sure the power is connected with the adapter (Output: DC5V, 500mA max, not included in the pack).
- It starts to charge when the charge indicator turns to blink slowly.
- If the indicator blinks fast, it may mean the charger is out of order. Please check the connection or power supply.
- The charge is done when the charge light from discontinues blink to turn off.
- If the brush has been unused for more than 6 months, charge it at least 12 hours to reach a full-charge.

Tips to prolong the battery lifetime

- Switch on to check if the battery is empty upon the first time you receive the device. If there is power, run it out before the first charge.
- After the first charge, do not recharge it between brushing. Recharge when it stops running.
- Fully discharge device at least once a year.

Pack Includes

1pc x device, 1pc x USB data cable , 1pc x user guide and replacement brush head below:

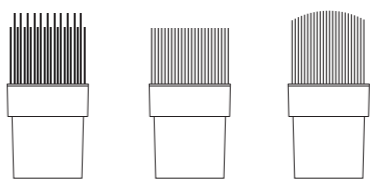

☐ Foundation / Stipple ☐ Foundation / Stipple ☐ Blush & Powder

How to Use

Fix Your Hair

Before applying makeup, pull your hair away from your face and secure with a hair tie or band.



Apply Your Makeup

For Liquid Makeup: use 1 finger to apply 1 dot to each part of your face. For Powder Makeup: dab the brush head directly into your makeup.



Start to Work

Turn on the brush so the brush head starts to rotate, slowly gliding across your face side-to-side and up-and-down while applying light pressure until your makeup is blended as desired.

For touch ups, repeat as necessary using a very small amount of additional makeup.

It is pretty easy to make the brush toggle back and forth between spinning mode 1 (Red: about 220 RPM), mode 2 (Green: about 180 RPM) and not spinning just by press the on/off switch.

188x132mm